

Type VN

Fits inside the re-entrant channel of several composite floor decking profiles including R51, Comflor® 51, Holorib®, Superib®, Multideck® 50 and MetFloor® 55.

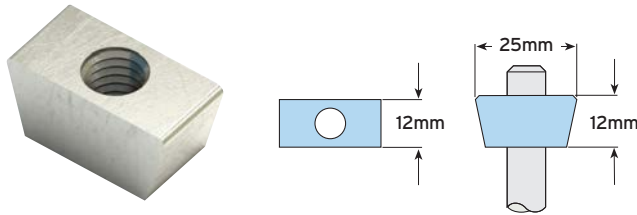

Material: Mild steel, zinc plated.

Product Code	Rod min 4.6	Safe Working Load (FOS 4:1) Tensile / 1 Rod kN	Tightening Torque Nm
VN10	M10	2.1	10

- Install the decking fixings after the concrete has been poured and has reached full strength.
- If the decking profile is deformed or distorted, do not install the fixing. If in doubt, contact Technical Support for advice.

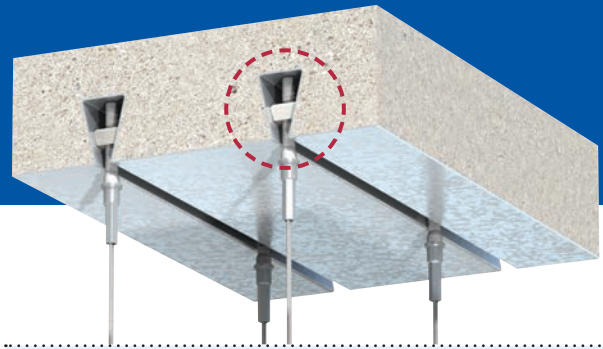

How to install...

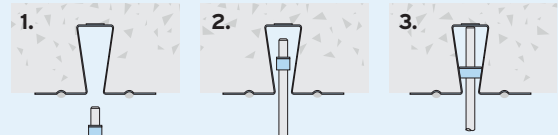

- 1) Screw V-Nut (VN) onto threaded rod.
- 2) Insert VN and rod into decking channel.
- 3) Rotate rod and VN through 90° so that the tapered edges engage the sides of the re-entrant channel.

Type TC - Toggle Clamp

Designed for service suspension from pre-cast hollow core slabs (minimum core depth 75mm) as well as SHS, steel sheeting or purlins.

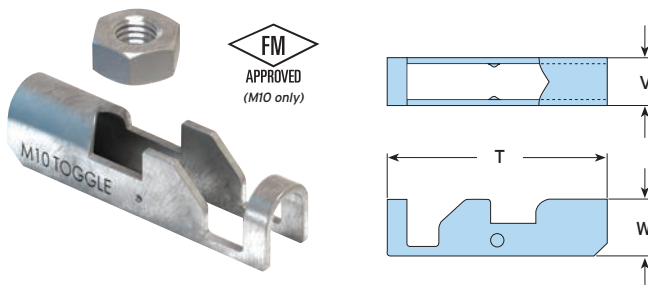

Material: Steel strip, zinc plated.

Product Code	Rod min 8.8	Hole Ø mm	Safe Working Load (FOS 4:1) Tensile / 1 Rod kN	Tightening Torque Nm	Dimensions		
					T mm	W mm	Width V mm
TC08	M8	22	2.45	10	68	16.5	13
TC10	M10	25	2.45	10	68	17.5	15

➤ SWL subject to the strength of the concrete section.

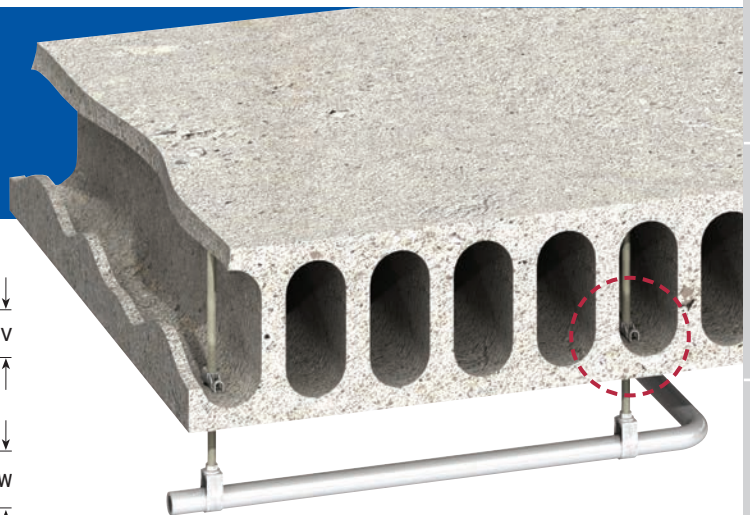

How to install...

- 1) Pre-assemble the fixing on the rod and insert into the hole (ensure it is central to the hollow core).
- 2) Shake the rod to allow the toggle body to locate horizontally across the hole, then lower the rod so that the nut locates in the toggle body.
- 3) Wind up the rod to the top of the section so it is as high as possible. Secure the assembly with a nut and washer.

